



Komet **EnDrive.**

State-of-the-Art-Motor.

Developed to meet your requirements.



reddot winner 2025
innovative design



Content.

4 5	Komet EnDrive.
6 7	Great economy.
8 9	Simple use.
10 11	Smart safety.
12 13	Optimize perfection.
14 15	Outstanding on its own. Even better as part of a team.
16 17	Tailor-made for your needs.
18 19	State-of-the-art design

Komet **EnDrive**.

Take your business to the next level - economically, simply and safely.



Our new, battery-powered endo motor with integrated apex locator has been specially developed for today's requirements and needs in dental practices. This makes your daily work economical, simple and safe.



Economical:

The EnDrive helps to save time, effort and costs through efficient processes - an investment that pays off every single day at the practice.



Simple:

It makes your work easier thanks to its intuitive operation and maximum flexibility. As a rule, you will master the technology after just a short training period.



Safe:

Our step-by-step advice and many new features minimize application errors, delays and interruptions.

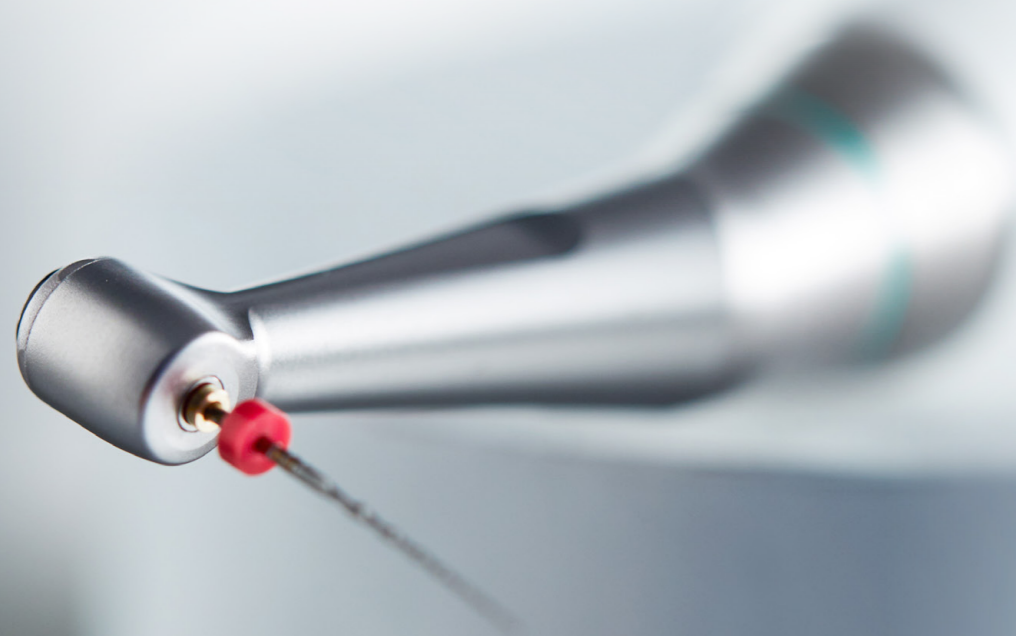

Great economy.

EnDrive pays off - every single day at the practice.

Irrespective of how many endodontic treatments you perform, no matter how you used to work up to now and regardless of the individual requirements you have to meet with your endo motor: Our new endo motor with integrated apex locator pays off every single day at your practice.

Take advantage of its improved features that reduce your workload. Find out how you can save time with the benefits of the EnDrive. After all, the expenses and the treatment time add up over time to a tidy sum that you can save at the practice.

Updates you don't have to worry about.

You don't need assistance to use the EnDrive. You don't even need anyone to keep your state-of-the-art engine up to date. The EnDrive takes care of the necessary software updates all by itself at the touch of a button. It does it automatically via WLAN, simply, quickly and without help. No more calling the service because the update is stuck. Your staff no longer has to take care of this. Haven't the best updates always been the ones you didn't notice, except that they were successful?



Full focus on what counts.

What counts is the treatment. Don't worry about sufficiently charged batteries or cables getting in the way during treatment. Concentrate fully on your work. The main unit and handpiece of the EnDrive are cordless and battery-operated. One battery charge is sufficient for a normal day's work and the charging process is completed in 1.5 to 2.5 hours. If necessary, you can even charge the EnDrive batteries during treatment. Your EnDrive is always ready to go, which significantly reduces delays or forced breaks.

Small contra-angle, great efficiency.

You think and act with foresight – and so does your EnDrive. Its integrated calibration function ensures perfect torque transmission. Calibration is quick, the benefit is long-lasting: Your EnDrive always works at optimum performance. The contra-angle is also electrically insulated, which saves valuable time. Thanks to the insulation, you don't need an additional silicone cover and you can conveniently avoid possible incorrect measurements in the event of unintentional contact in the oral cavity. For more efficiency, fewer treatment breaks and interruptions.

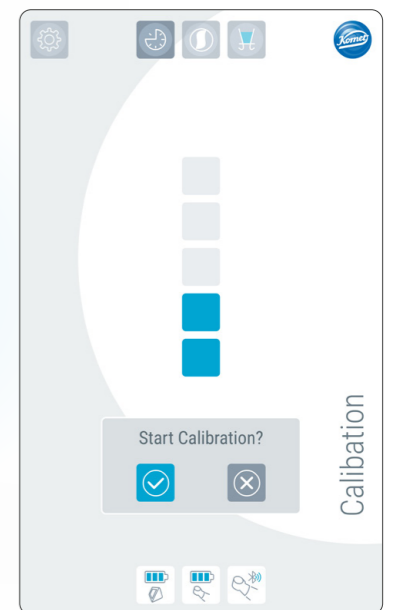

Simple use.

EnDrive makes complex treatments easy..

All dentists carry out their endodontic treatments according to their own habits. So feel free to perform yours exactly the way you're used to. As simply and in as much comfort as possible. The EnDrive has been designed so that users can work exactly as they are used to - with all the added benefits of state-of-the-art technology. Endodontic treatments are complex enough, so why not make them as easy as possible with the help of today's technical possibilities? Your EnDrive not only fits easily onto the tray, but above all it meets your wishes and requirements.

Better than easy, it's intuitive.

The EnDrive will make you perfect even without much practice. The menu structure has been carefully designed so that even inexperienced users will find their way around after just a short training period. So there's no need to hesitate: we will accompany you with our qualified step-by-step advice for as long as you wish and definitely until you feel absolutely confident. You will appreciate the benefits of the clearly laid-out 7-inch color and touch display, which can be operated intuitively at the touch of a finger. Not only will you quickly find your way around, but the clear structure and overview means you can always see everything you need to see in the blink of an eye. Favorite files, sequences, processing progress with colored depth marks, you have all the information you need at a glance. Adjust the setup, switch between settings – simply with a tap of the finger. This is a huge relief and time saver, especially when things have to be done quickly. Plus: fewer buttons for less risk of contamination. Simply install the device, get started and enjoy the long-term benefits.

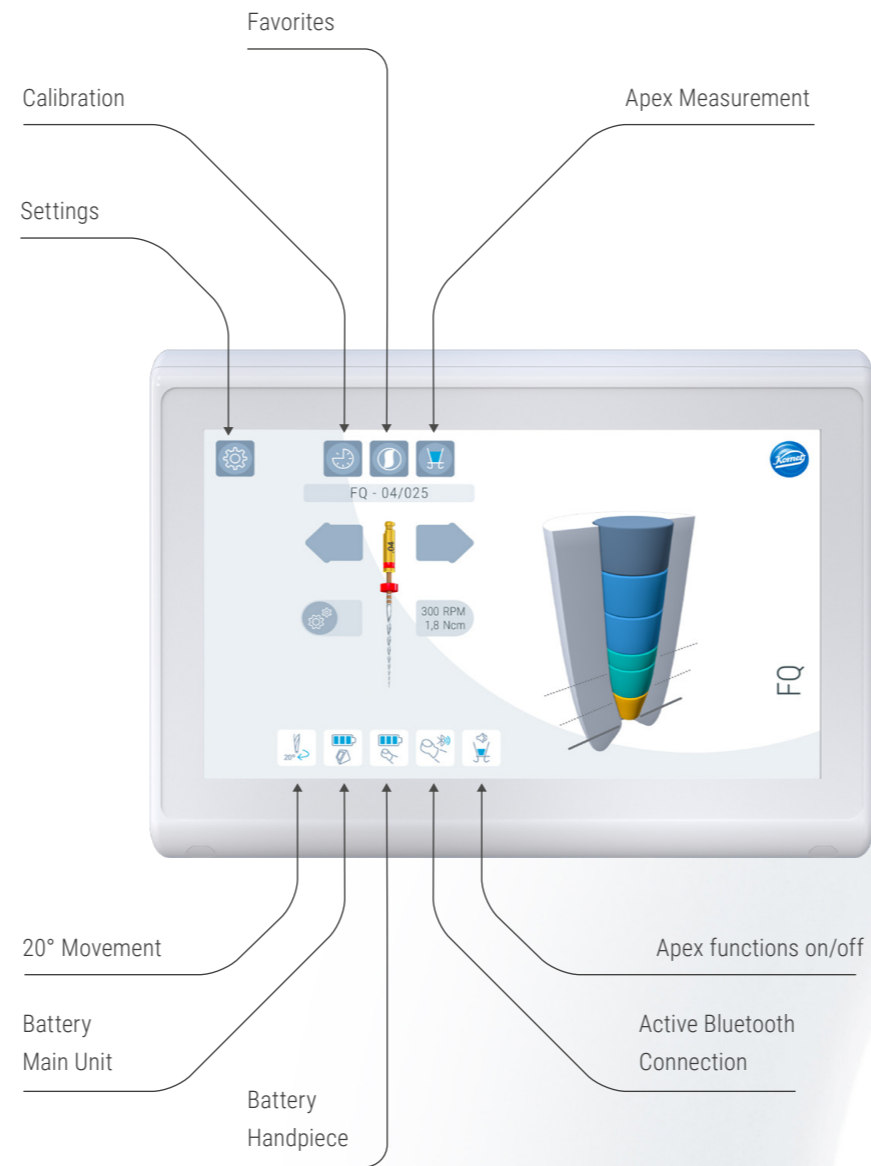

Efficiency is a matter of habit.

Everyone has different preferences and wishes when it comes to endodontic treatments. The EnDrive fulfills almost all of them. Its ergonomic handpiece is designed for both right-handed and left-handed users, for delicate work and mobile use. The display can be used vertically and horizontally so that you can always read it with ease. "Rotary" or "reciprocating" is no longer a matter of choice, but a matter of habit. The EnDrive can do both and simply follows your instructions. What's more, its comprehensive file library contains almost all endo files on the market, including preset values such as speed or torque. Simply use up your old stock of files or continue using

what you love!

Compact, convenient and cordless if required.

The EnDrive does not create any work for you so that you can do yours even better. Thanks to its compact dimensions, its use in both portrait and landscape format and its light weight, it can be used flexibly and fits on almost any tray. The ergonomic handpiece can be conveniently docked onto the magnetic holder of the main unit, so you can easily carry the entire system into the next room with one hand. Enjoy complete freedom at work - almost entirely without jangling cables and too many buttons that need to be pressed.

Smart safety.

No compromises when it comes to safety.

When it comes to safety, don't just rely on your instincts, but on safety à la Komet. Reduce file fracture, incorrect measurements and other delays as much as possible with the latest technology. Decrease the risk of contamination where hygiene requirements are particularly high. Minimize the risk of overpreparation where millimeters count. The EnDrive provides you with the best possible support.



Precision work, just the way you want it.

If you have to deliver top performance and precision work, you need the best precision tools. You can rely on the patented apex locator, with which you always know exactly where you are. Our apex locator is already integrated into the EnDrive and takes highly precise measurements in real time, while you continue to concentrate on your work. You have precise control over the preparation depth at all times. You can even continue to use your manual files. Simply use the corresponding file clamp and the separate cable.



Perfect working conditions down to the smallest details.

Improve your working conditions with our enhanced endo features. For example, the contra-angle head of the EnDrive is our smallest to date and offers the best view of the working area. Not only that, it can also be rotated 360 degrees so that you can adjust it to suit your holding preferences at any time. The magnetic holder on the main unit is brand new. Thanks to it, you can attach your handpiece to the motor in a flash if you need to move quickly or if there is no helping hand nearby. It also reduces the risk of contamination and allows you to transport the entire system with just one hand.

Working in complete safety, even near the limit.

Every delay leads to costly loss of time. With the safety features of the EnDrive, delays can be reduced to a minimum. Your handpiece is provided with a new LED ring which lights up in addition to the warning on the display of the main unit and an acoustic signal which sounds before you reach a critical torque value. This allows you to work with precision within the limit range and minimizes the risk of file fracture. Forced treatment pauses can be reduced with the EnDrive's auto-stop and auto-reverse functions. Depending on your requirements, the file stops when necessary or rotates freely in the opposite direction before file fracture occurs – regardless of whether you are using rotary or reciprocating files.

Tailor-made for your workflow.

From the choice of file to the apex.

Always the right file.

Simply proceed in the way that has always worked for you: With the EnDrive, you have your favorite file ready for use and the right settings on the display when you need them. The My-File function enables you to create up to three customized file sequences from the comprehensive file database. With the EnDrive, you're ready to go: just tap the touchscreen to perfectly align your pre-curved file for insertion into the canal. Press the button on the handpiece briefly to change the file within a sequence in a matter of seconds.

Safe auto functions

Precision down to the last millimeter: The EnDrive supports you with intelligent auto functions during preparation in the apex area. Depending on the setting, your file stops or pauses or rotates in the opposite direction when you reach the preparation length. Do you need peace and quiet to concentrate on your work? Deactivate the apex sound and functions and concentrate fully on the visual display and your patient.

Gain time, routine, and confidence!

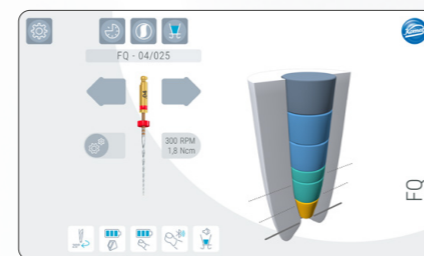
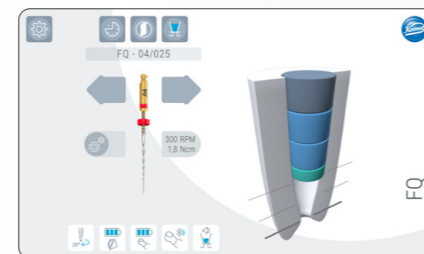
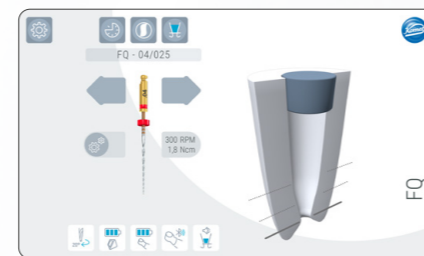
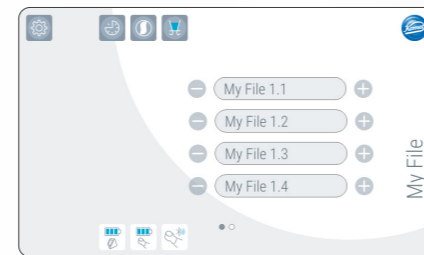

State of the Art.

Right down to the functional design..

Red Dot Design Award Winner.

The Red Dot Design Award counts among the most important design competitions in the world. The criteria for being presented with the award are innovative power, usability, functionality and sustainability. The EnDrive was presented with the Red Dot Design Awards because its design pursues a clear goal – to make your work easier.

You can fully concentrate on your patients thanks to the clear, intuitive user interface. Minimize risks, for example of file fracture, thanks to well thought-out features such as the LED ring on the handpiece. Benefit from the flexibility afforded by its design: vertical and horizontal use, ergonomic handpiece for precise work, suitable for both left and right-handed users, almost cordless design for greater convenience and mobile use in several rooms. Plus: fewer buttons for a reduced risk of contamination.

A long service life is guaranteed thanks to the high-quality workmanship you have come to expect from Komet. Discover a design that is fully focused on functionality in order to further promote your business.



reddot winner 2025
innovative design



Optimize perfection.

With the matching FQ and Procodile Q files.

Use the finest details to further optimize the benefits of your EnDrive with the right files. With our rotary FQ file system and our reciprocating Procodile Q file system, you can add another Komet component to your endodontic system, making your treatments simple, economical and safe.

High efficiency and flexibility.

Reduce the risk of file fracture even further and increase the efficiency of your treatments while maximizing safety with our FQ and Procodile Q file systems. Both files are heat-treated. For you, this means that both systems, whether rotary or reciprocating, are particularly flexible, can be pre-bent with ease and remove infected tissue with unsurpassed efficiency.

In addition, the file cores are variably tapered: The diameter decreases towards the shank while the taper remains the same on the outside. This means that each file can be perfectly adapted to your individual

requirements and debris is removed in the best possible way because the files are provided with a large chip space. Thanks to the heat treatment and the variable file core, the files follow even strongly curved root canals, thus ensuring a successful treatment in difficult anatomical conditions.

Outstanding on its own. Even better as part of a team.

EnPack und EnFill – to ideally complement the EnDrive for economical, simple and safe root canal obturations.

EnPack.

With our obturation device for warm, vertical obturation of the apical third, you can complete your endodontic treatment with a perfect outcome.

You are ready for action at any time, can get started straight away and work efficiently without interruptions. The heating tip heats up in just 0.2 seconds, so you don't lose any valuable time during work and stay in the workflow. Simple plug-and-play operation, a display that is easy to read in any position and a powerful battery ensure that you only have to worry about your patient and not the technology.

EnPack makes clean, precise work particularly easy. It is suitable for universal use, i.e. by those who prefer a purely manual preparation as well as in conjunction with any endodontic motor. The nine heating tips with different diameters always offer an optimum view of the working area.

Thanks to the low weight and ergonomic design of the device, you can work without fatigue. Precise separation of the master point is easy with the heating tip even when working with single-post obturations - without clogging up and the risk of pulling the gutta-percha out again.

Rapid heating in the root canal ensures maximum patient safety and a perfect, homogeneous result.



EnFill.

Our obturation device for warm, vertical obturation of the central and coronal third of the root canal ensures the best possible conclusion of your endodontic treatment. Thanks to the powerful rechargeable battery and the short heating time of only around 15 seconds, you are ready to go in no time at all and can carry out your filling without interruptions or delays.

The six injection needles available can be perfectly adapted to the requirements of the root canal and your holding preferences, as they can be rotated by 360°.

They are so thin that you always have an unobstructed view of the working area, thus enabling you to fill the canal safely and precisely up to 3 mm before the apex. Intuitive operation, fast responsiveness and fatigue-free design save valuable time during every endodontic treatment. The EnFill can be used for manual processing and in combination with any endo motor.

The light, ergonomic handle gives you full control over the filling volume and flow speed so that you can follow your own workflow. Whether you use it on its own or with the EnPack as an ideal partner - with EnFill you also reap the benefits from all the challenging work you have previously done with your root canal preparation.



Developed to meet your needs.

All this is in the EnDrive.

Scope of delivery:

Every EnDrive is equipped with everything you need for successful root canal preparation, e.g. a lip clip and file clamp for length measurement with mechanical files. Not included in the scope of delivery, but always at your service: our qualified step-by-step advice, which accompanies you until you feel absolutely confident. The EnDrive was primarily developed to meet the individual demands you place on endodontic treatments. In addition, it goes without saying that it also complies with all important requirements of current certifications and the usual practical requirements.

	Scope of delivery
1	EnDrive Main unit
2	EnDrive Handpiece
3	EnDrive Contra-angle
4	EnDrive File clip
5	EnDrive Lip clip
6	EnDrive Apex cable
7	EnDrive Handpiece cable
8	Charging cable incl. EU, UK, US, AU plug
9	Servicing adapter
	Inserts
	Instructions for use



Spare parts and accessories:

Do you need a spare part or would you like an additional accessory for your endodontic treatments? No problem. With our service à la Komet, you will receive whatever you need immediately - original and in top quality.

REF	Spare parts/accessories
6	ED02 EnDrive apex cable
4	ED03 EnDrive file clamp
5	ED04 EnDrive lip clip
3	ED05 EnDrive contra-angle
2	ED06 EnDrive Cale handpiece
8	ED07 EnDrive AC/DC adapter

Komet Dental

Gebr. Brasseler GmbH & Co. KG
Trophagener Weg 25 · 32657 Lemgo
Postfach 160, 32631 Lemgo · Germany
Telefon +49 (0) 5261 701-0
hello@kometdental.com
Contact for dealers:
export@kometdental.de

Verkauf Deutschland:

Telefon +49 (0) 5261 701-700
Telefax +49 (0) 5261 701-289
info@kometdental.de
www.kometdental.de

Export:

Telefon +49 (0) 5261 701-0
Telefax +49 (0) 5261 701-329
export@kometdental.de
www.kometdental.com

Komet Austria Handelsagentur GmbH

Hellbrunner Straße 15 · 5020 Salzburg
Telefon +43 (0) 662 829-434
Telefax +43 (0) 662 829-435
info@kometdental.at
www.kometdental.at

Komet France

18 rue · Fourcroy · 75017 Paris
Phone +33 (0) 1 43 48 89 90
info@komet.fr
www.komet.fr

Komet Italy

Via Gianbattista Morgagni 36,
37135 Verona
Phone +39 (0) 45 11171911
info@komet.it
www.komet.it

Komet UK

Invoice and general correspondence:
27 Old Gloucester St,
Holborn, London WC1N 3AX
info@kometuk.com
www.kometuk.com

Brasseler®, Komet®, Art2®, CeraBur®, CeraCut®,
CeraDrill®, CeraPost®, DC1®, DIA0®, EnDrive®, EnFill®,
EnPack®, FastFile®, F360®, F6 SkyTaper®, FQ®, H4MC®,
Komet BioSeal®, OccluShaper®, OptiPost®, PolyBur®,
PrepMarker®, Procodile®, Rocky®, SHAX® are registered
trademarks of Gebr. Brasseler GmbH & Co. KG.

Some of the products and designations mentioned in
the text are trademarked, patented or copyrighted.
The absence of a special reference or the sign ® should not
be interpreted as the absence of legal protection.

This publication is copyrighted. All rights, also with regard to
translation, reprint and reproduction (also in the form of
extracts) are reserved. No part of this publication may be
reproduced or reprocessed using electronic systems in any
form or by any means (photocopying, microfilm or other
methods) without the written permission of the editor.

Colours and products are subject to alterations.
Printing errors excepted.

As at August 2025